

Pro:Centric® Server

▶ **PCS400R**



LG's PCS400R Pro:Centric® Server is a stand-alone, remotely-controlled processor and controller for the Pro:Centric system. The server enables system providers to create and remotely manage application content for LG commercial TVs over RF or IP distribution networks, using either the Pro:Centric Java Application (PCA) or the new Pro:Centric Direct (PCD) HTML Application.

The PCS400R can also be used to remotely edit the televisions' FTG ("Free-To-Guest") channel map and installer menu configuration, dramatically reducing installation cost and future room visits.

Utilizing a spare RF channel for communications, the PCS400R broadcasts it's information to Pro:Centric enabled TVs enabling guests to select customized content for in-room viewing using the TV remote control, such as hotel amenities, daily weather, and interactive electronic program guide (EPG). The server captures data updates via the Internet to populate its EPG, weather forecast and other services, enabling the most up to date information to be presented to the guests' TVs.

The PCS400R supports eight contiguous 256-QAM channel output. One QAM channel is allocated for Pro:Centric data delivery and the other seven provide the ability to play 2 or 3 videos per QAM channel for a maximum of 21 video stream playouts from the server (depending on the bit rate and bandwidth). A dedicated Ethernet output port is also provided to enable IPv4 multi-cast broadcast of content over an IP network. Video files are stored on the internal Solid State Disk Drive (SSD).

The Pro:Centric server also supports delivery of 3rd Party developed Applications (Java™/Adobe® Flash®) available from LG's software developer partners to Pro:Centric televisions, "OEM Mode".

Features

Simple Installation

Uses the existing RF/IP network, internet connection input, and modulated RF (QAM), IP or ASI output.

Minimal Head-End Rack-Space

Small, lightweight chassis, 1U height profile, 19-inch rack-mountable.

High Reliability

The PCS400R design has 'no moving parts' with solid state memory and no internal disk to provide a highly reliable hardware platform.

Remote Support

Remote administration, configuration, and maintenance via VPN server; Management of television channel map and installer menu settings.

(New) Supports Pro:Centric Direct (PCD)

The PCS400R supports LG's new Pro:Centric Direct, HTML5 Content Management Software. Pro:Centric Direct offers a comprehensive UI (User Interface) Editor, along with customizable widgets and multiple theme templates to enable system integrators to create a unique guest user experience and express the hotel's brand identity and individuality through LG's Pro:Centric In-Room television.

UI Editor

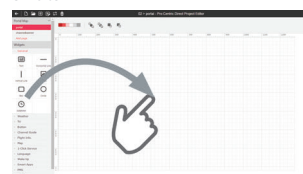

Drag & Drop Widgets



UI Design Templates

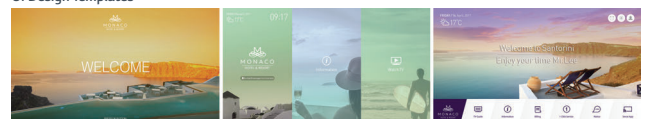

Cinematic Type

Grid Type

Bar Type

Pro:Centric Server

PCS400R

SERVER ADMIN CLIENT

PCA or PCD Admin Client Graphical User Interface (GUI) is provided and is remotely accessible via the Internet using VPN service and a standard web browser, to provide System Integrator administration users with a full suite of features to manage and support the Pro:Centric system, including:

- System status and logs, and server settings
- Configuration for Channel lineup and Electronic Program Guide
- UI Editor and customization tools
- Managing television configurations settings and software updates



For further details, refer to the appropriate Pro:Centric™ Admin Client User Guide (also accessible on the system).

TYPICAL FTG Pro:Centric PCS400R INSTALLATION

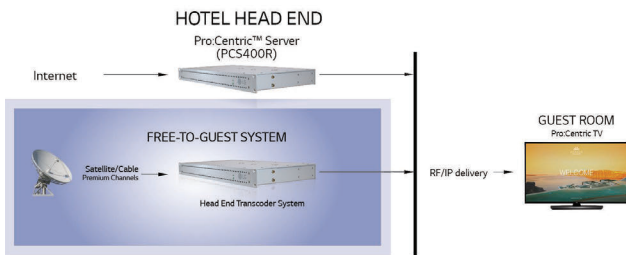

PRO-CENTRIC VPN SERVER

Remote management of the PCS400R server functionality is provided via a secure, built-in VPN client that connects to the centralized VPN server. In this way, remote configuration management, remote software updates and other services are supported. Free hosting of the service is provided by LGE during the warranty period. Extended support plans are available.

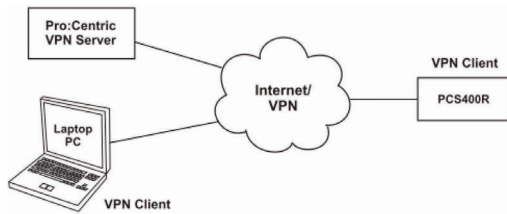

INSTALLATION REQUIREMENTS:

Installation of the PCS400R requires the following:

- 1U rack space in the Head-end room
- Ethernet Connection (VPN and FTP open)
- 1 x 110/1 20VAC power outlet
- 1 coax drop to the RF combiner to feed the output of the server into the RF network or 1 Ethernet cable to connect Feature Port to the IP network switch

SYSTEM SOFTWARE	Model	PCS400R	
SOFTWARE	Software	Linux OS kernel 3.10 PCA (Java) and PCD (HTML) server applications	
	Data Output	ASI,RF, 100/1000T Ethernet	
ELECTRICAL	Rear Port	ASI/RF/RF Tap/TTL serial, Ethernet 2 Port	
	DC Input	+19V DC @ 2.2 Amps Adaptor	
	RF Output Connectors (2)	75 Ohm, Type 'F'	
	RF Output Span	Up to 8 Contiguous Channels (Typically 48-64 MHz)	
	RF Output Frequency Range	54 MHz to 865 MHz	
	Active Output Level	-1 dBm (+47.75 dBmV) Typical	
	Test Output Level	-47.75 dBm (+1 dBmV) Typical	
	Frequency Accuracy	+/- 5 ppm	
	ASI Out Jack	75 ohms, BNC	
	Level at ASI Out Jack	800 mv	
	Ethernet Connector (Control Port)	10/100/1000BaseT, RJ-45	
	Ethernet Connector (Feature Port)	100/1000BaseT, Full Duplex RJ-45	
	RS-232 Serial Audio Jack	Command Line Interface port (5V TTL)	
	CPU/Memory / Storage		64 bit Intel Atom (4 Cores @ 1.91GHz) processor
		8GB memory	
		275GB SSD	
MODULATION SPECIFICATIONS	Standard	ITU-T J.83 Annex B (QAM-B)	
	Constellations	64-QAM, 256-QAM	
	Symbol Rate	64-QAM	5.056941 MBaud
		256-QAM	5.360537 MBaud
	Interleaving	Fixed I = 128, J = 1	
	Standard	EN 300 429 V1.2.1 (DVB-C)	
	Constellations	64-QAM, 256-QAM	
	Symbol Rate	64-QAM / 256-QAM	5.056 MBaud
		64-QAM / 256-QAM	6.111 MBaud
		64-QAM / 256-QAM	6.9 MBaud
Standard	ABNT NBR 15601:2007 (ISDB-T)		
Parameters	64-QAM, 7/8 Convolutional Code, 1/32 Guard Interval Ratio, 2K FFT, 13 Segments		
Sample Rate	8.126984 Ms/s		
ENVIRONMENTAL OPERATING CONDITIONS	Temperature	32° to 104° Fahrenheit	
	Humidity	95% non-condensing	
ENVIRONMENTAL STORAGE CONDITIONS	Storage Temperature	-4° to 158° Fahrenheit (-20° to 70° Celsius)	
	Humidity	95% Non-condensing	
CERTIFICATION	Regulatory Compliance	FCC, UL, RoHS	
DIMENSIONS	Unit Dimension (WxHxD, mm)	19.0" x 1.7" x 8.5"	
	Unit Weight (Rack-only)	5.65 lbs.	
OTHER	Warranty	1 Year	
	UPC	7 19192 91975 4	

REAR VIEW

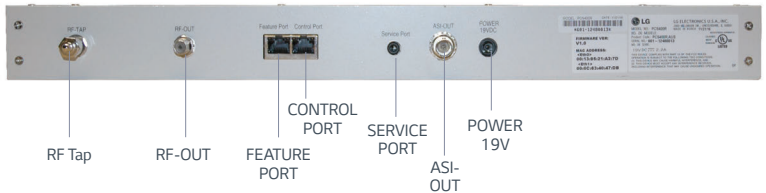

Pro:Centric

All screen images are simulated. Dimensions and weights are approximate. Design, features and specifications subject to change without notice.

© Copyright 2019 LG Electronics, Inc. All Rights Reserved. The "LG" logo is a registered trademark of LG Electronics Inc. Pro:Centric is a trademark of LG Electronics Inc. All other product and brand names are trademarks or registered trademarks of their respective companies.